

PB-1000-01

in Grommet Bumper B

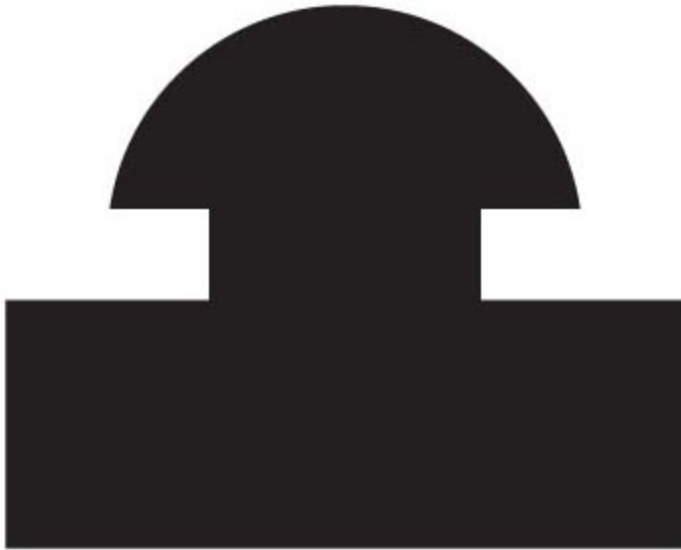

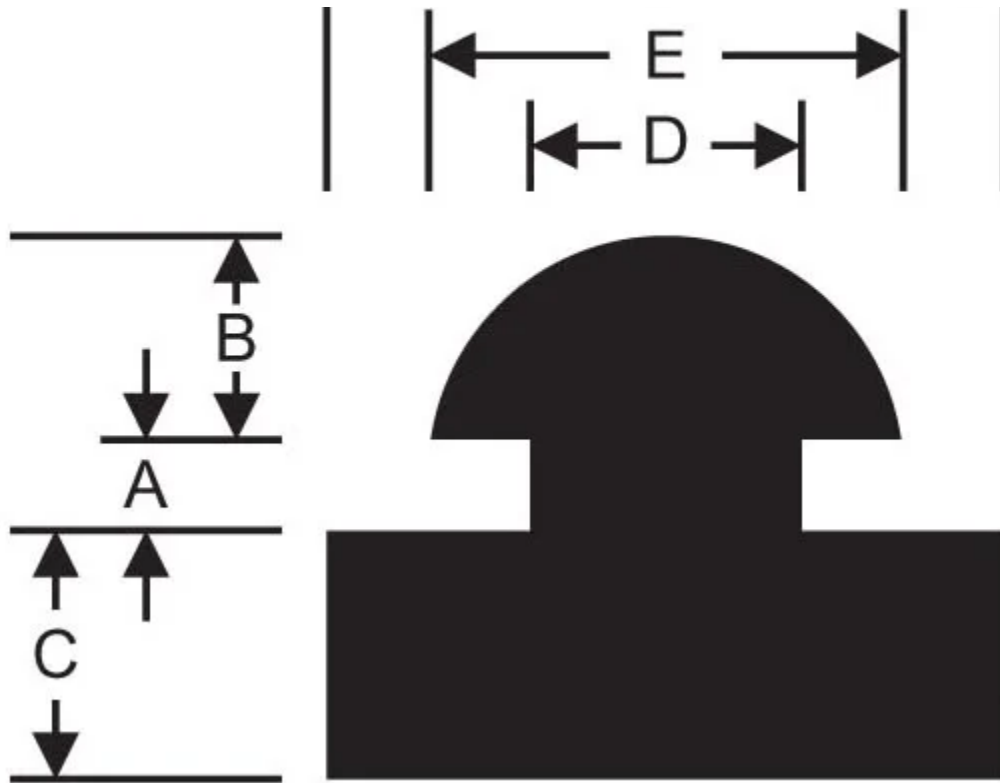

RPM's rubber recessed bumpers are used to protect doors or truck bodies from damage. They are also used as feet for large vibrating equipment.

RPM's rubber bumpers are a low cost way to provide a rubber break for many different applications. They provide a great way to protect and isolate any two surfaces. If you need a special size, contact us and see how we can help!

Specifications

GROOVE WIDTH (A) (IN)	3/16
HEAD HEIGHT (B) (IN)	3/16
BASE HEIGHT (C) (IN)	5/16
GROOVE DIAMETER (D) (IN)	1/2
HEAD DIAMETER (E) (IN)	11/16
BASE DIAMETER (F) (IN)	1
PRODUCT TYPE	Bumpers
MANUFACTURER	RPM Mechanical, Inc.

